

DESCRIPTION

- SMD LED technology for indoor installation.
- Hours and minutes display.
- Fixed or alternate time with date or week number display or temperature (integrated probe).
- Height of digits 10 cm, optimal viewing distance: 40 metres.
- Angle of vision: 120°.
- LED colours: red, green, yellow, blue and white.
- Models: independent, impulse, wireless (FI+DCF), wireless DHF, AFNOR and NTP.



STANDARDS

- EMC: - EN55032.
- EN55024.
- LVD: EN60950.
- R&TTE (radio models): EN301-489-3.

GENERAL FEATURES

- **Adjustable brightness**..... 4 levels.
- **Display mode**..... 12 or 24 hour.
- **Eco mode**..... Programmable energy saving or predefined over a time period.
- **Time change**..... Automatic summer/winter time changeover and perpetual calendar.
- **Time base backup**.....
 - Independent model: 15 days in case of power failure.
 - Impulse model: in case of power failure, data saving and impulses reception without battery.
 - Synchronised models: at each start the clocks wait for the synchronisation signal.
- **Time accuracy**..... 0.2 second/day (except NTP model: precision dependent on the time server).
- **Operation**..... Silent.
- **Digit**..... 7 segments with 5 LEDs each.
- **Hours and minutes separating**..... Colon made of LEDs.
- **Configuration**..... 2 capacitive buttons.
- **NTP model**.....
 - Synchronisation unicast, multicast and by DHCP.
 - Advanced configuration from the embedded web server.

See product page on
>> www.bodet-time.com <<



MECHANICAL FEATURES

- **Construction**..... ABS/PMMA black (IP30, IK02) and PPMA Poly (methyl methacrylate) cristal.
- **Operating temperature range**..... -5 to +55°C.
- **Weight**..... 1.8 Kg.
- **Dimensions**..... 517 x 208 x 72 mm (see on the back).

ELECTRICAL FEATURES

- **Power supply**.....
 - Independent, impulse, AFNOR and wireless DHF models: 100-240VAC.
 - Wireless (FI+DCF) model: 230VAC.
 - NTP model: PoE (Power over Ethernet) – class 0.
- **Consumption max**..... 5 W.
- **Electric protection (except NTP model)**..... Class 2.

STYLE 10 REFERENCES (BY SYNCHRONISATION)

- **946 71x**..... Independent model
- **946 72x**..... Impulse model
- **946 73x**..... FI + DCF model
- **946 74x**..... DHF model
- **946 75x**..... AFNOR model
- **946 77x**..... NTP model
- **946 005**..... Mounting on hanging bracket
- **946 006**..... Wall mounting



• Specify the LED colour by replacing the "x" in the reference number by: 1: red - 2: green - 3: yellow - 4: blue - 5: white



WALL MOUNTING

Dimensions in mm

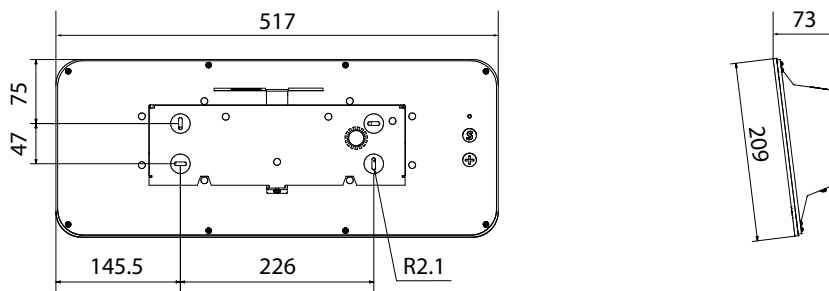

MOUNTING ON HANGING BRACKET

- The hanging bracket makes it possible to hang the clock from the ceiling or from the wall.

Dimensions in mm



DESCRIPTION

- Style 10 recess mounting digital clock having the same electronics and the same operation than the normal version. However the mechanics are different to allow for recess mounting in a wall.
- LED colour: red.
- Models: independent, impulse, AFNOR and NTP.

RECESSED VERSION



GENERAL FEATURES

- Same as Style 10 normal version (see page 1).

MECHANICAL FEATURES

- **Construction**..... Black steel (IP30, IK02) and PPMA Poly (methyl methacrylate) cristal.
- **Operating temperature range**..... 0 to +50°C.
- **Weight**..... 1.220 kg (NTP : 1.180 kg).

ELECTRICAL FEATURES

- Same as Style 10 normal version (see page 1).

DIMENSIONS

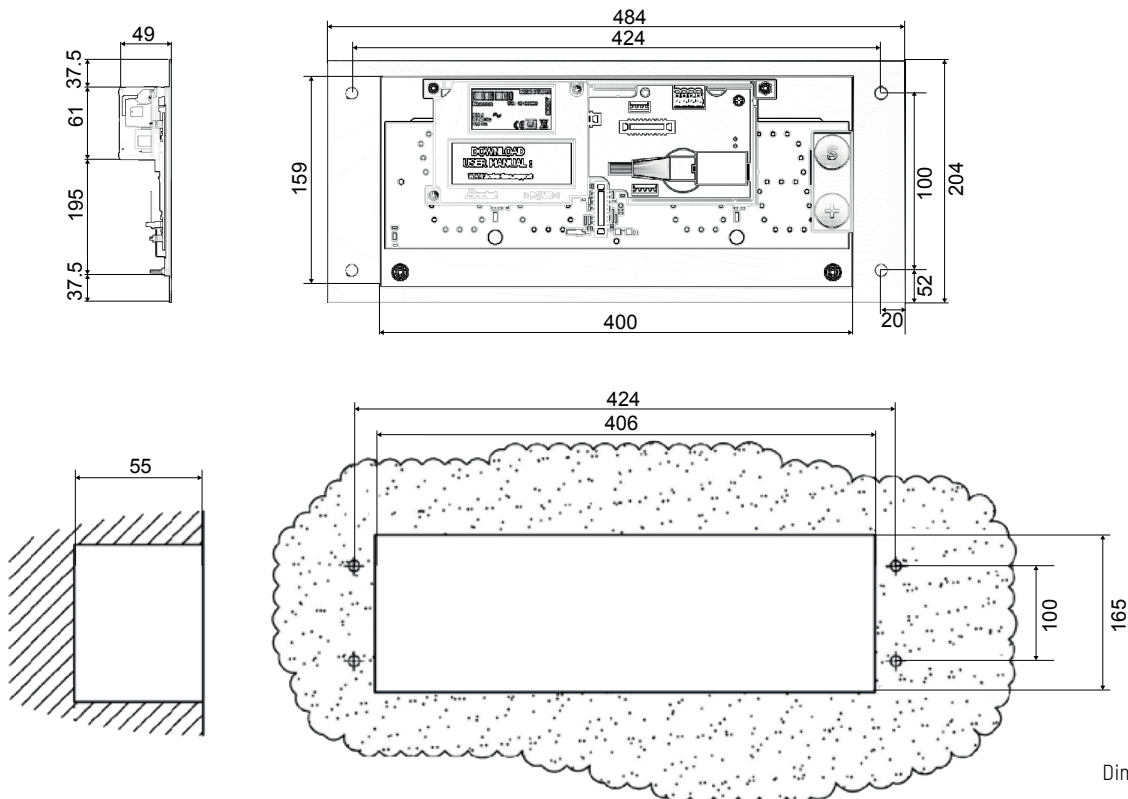

STYLE RECESSED 10 REFERENCES (BY SYNCHRONISATION)

- 946 711 F..... Independent model
- 946 721 F..... Impulse model
- 946 751 F..... AFNOR model
- 946 771 F..... NTP model
- 946 017..... Back cover for recess mounting

DESCRIPTION

- Style 10 waterproof digital clock having the same electronics and the same operation than the normal version. However the mechanics are different to allow for an IP55 Ingress protection rating.
- LED colours: red.
- Models: independent, impulse, AFNOR and NTP.

WATERPROOF VERSION



GENERAL FEATURES

- Same as Style 10 normal version (see page 1).

MECHANICAL FEATURES

- Same as Style 10 normal version (see page 1).
- In order to guarantee an IP55 Ingress Protection, the grommets are waterproof and silicon seals are installed between the bracket and the clock casing.

ELECTRICAL FEATURES

- Same as Style 10 normal version (see page 1).

DIMENSIONS

- Same as Style 10 normal version (see page 2).

STYLE 10 WATERPROOF REFERENCES (BY SYNCHRONISATION)

- 946 711 A..... Independent model
- 946 721 A..... Impulse model
- 946 751 A..... AFNOR model
- 946 771 A..... NTP model